

THIRD ANGLE PROJECTION

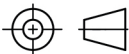

FOR GUIDANCE ONLY
THIS INFORMATION HAS BEEN
PROVIDED IN GOOD FAITH BUT
SPECIFICATIONS DO CHANGE

Edition B

Date 06/07/10

Scale 1:1 @ A4

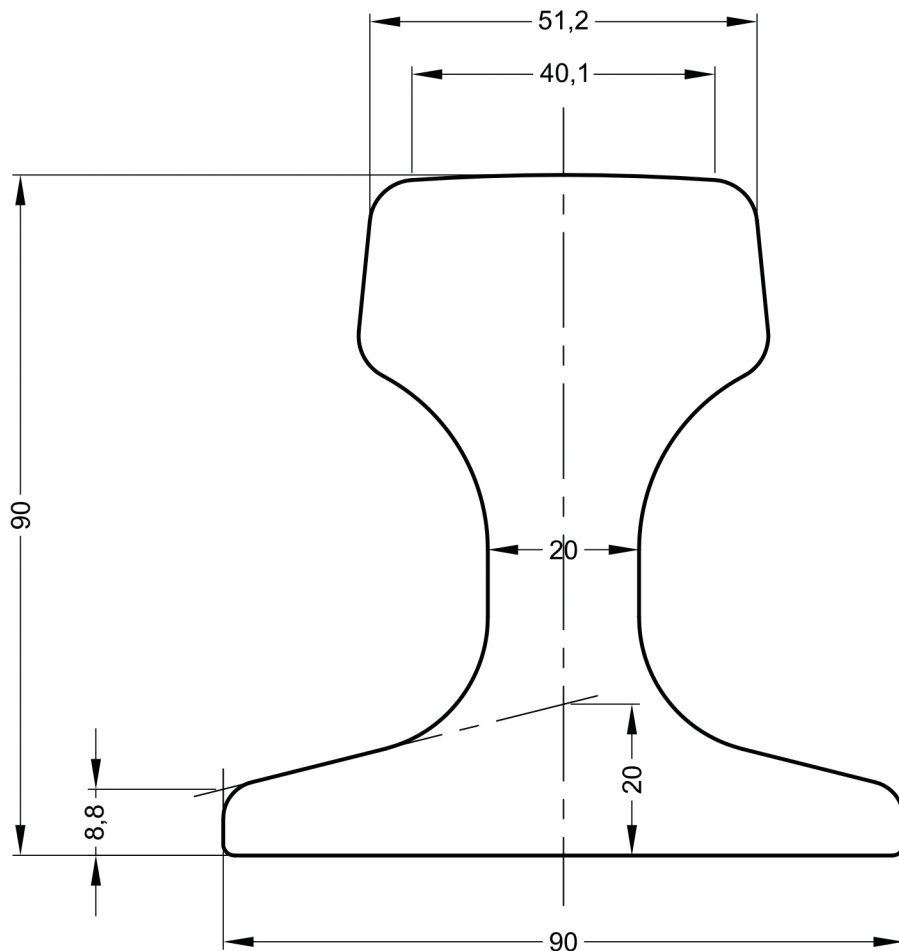

NOTE: THE PROPERTIES SPECIFIED BELOW HAVE BEEN CALCULATED USING AUTOCAD SOFTWARE AND ARE ACCURATE AT THE TIME OF THIS DRAWING ISSUE. THESE FIGURES MAY DIFFER SLIGHTLY FROM THOSE PUBLISHED IN THE STANDARD FOR THE RAIL.



**Anyang General International
Co., Ltd.**

Tel: +86 372 5081 703
Email: info@rail-fastener.com
http://www.rail-fastener.com

Rail Designation	ISCR 50
Rail Origin	INDIA
Standard	IS 3443-1980
Area of section	3799 mm ²
Calculated Mass	29.8 kg/m
Neutral Axis to base	42.7 mm
Moment of Inertia	Ixx 347 cm ⁴ Iyy 107 cm ⁴